

HIGH LOW THERMOSTATIC MIXING VALVES

ECO-MIX™ XL-200-SW-LF-DT-RF-R1 5-208 GPM (18.9-787 l/min)

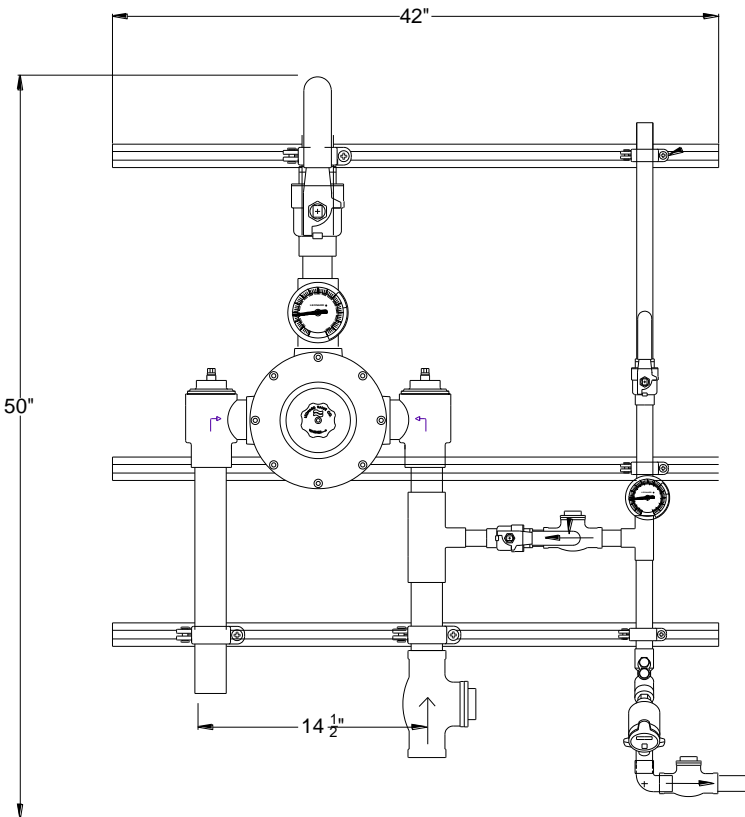

- High Low Thermostatic Water Mixing Valve with 5 GPM (18.9 l/min) minimum flow capacity
- 2" inlets, 2" outlet (51 mm x 51 mm)
- Integral combination checkstops with strainers and wall support
- 125 PSI (8.6 BAR) maximum operating pressure
- Copper encapsulated thermostatic assembly with shuttle
- Locking temperature regulating handle set for 120°F(49°C)*
- Temperature adjustment range, 95-135°F (35-57°C)**
- Bottom inlet supply / top outlet connections
- Outlet ball valve with thermometer
- 1" Return loop with thermometer
- Ball valve
- 1" circuit setter valve
- Check valves on either side of circuit setter valve
- Complete unit mounted on heavy duty strut, for ease of installation
- Valve assembly rough bronze finish
- Factory assembled and tested
- See Flow Capacity Chart reverse side
- Internal parts of bronze, brass, and stainless steel



WARNING: This product can expose you to chemicals including lead, which is known to the State of California to cause cancer. For more information, go to www.P65Warnings.Ca.gov

Valve assembly is certified to meet Low-Lead requirements of wetted surface area containing less than 0.25% lead by weight. All other fittings and components, the sum total of which comprise the wetted surface of this product contains less than one quarter of one percent of lead by weight.

ASSE 1017 Certified



Valve is CUPC certified



NOTE: Leonard Valve Company reserves the right of product or design modification without notice or obligation

+NOTE: The valve will maintain temperature with 0.5GPM flow from the domestic hot water loop when properly installed near the hot water source with a continuously operating recirculation pump.

****NOTE:** For temperatures outside of this valve's stated range, please see our line of bi-metal valves.

****NOTE:** A locking temperature regulator set for 120°F (49°C), is simply a mechanical setting to prevent unauthorized temperature set point changes. If incoming water is hotter than 150°F (65.5°C), the temperature of the factory test, the valve may deliver in excess of 120°F. **MUST BE RESET BY THE INSTALLER**

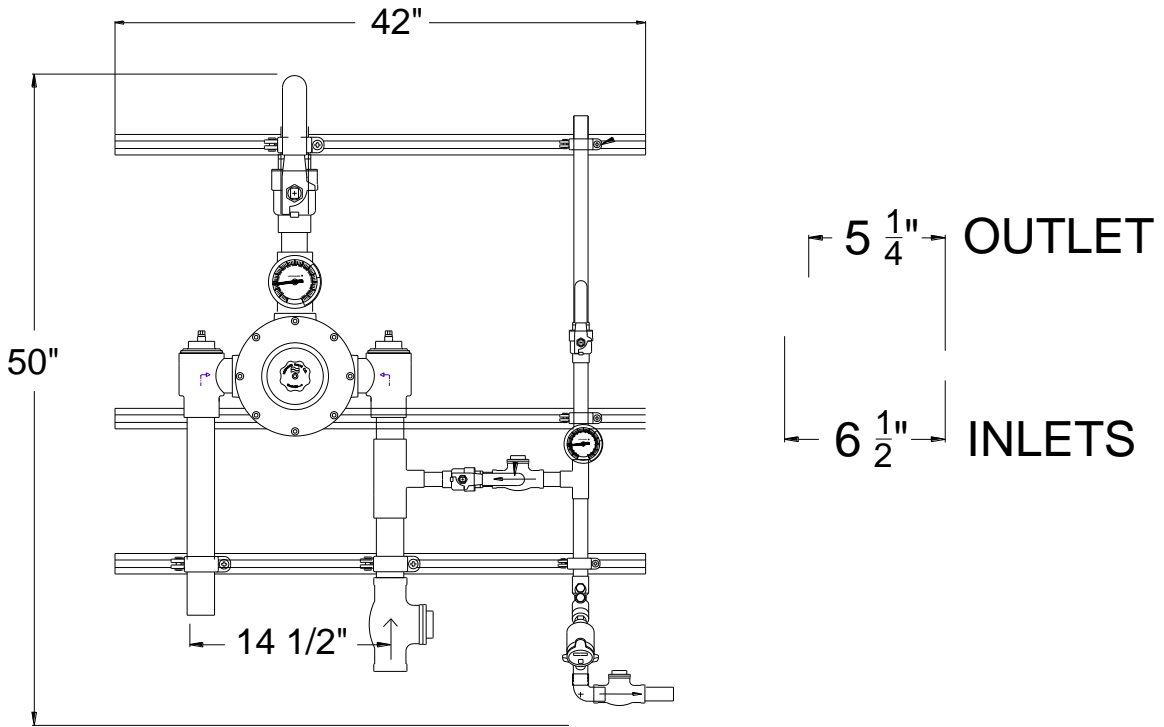

PRESSURE DROP											
MIN+ FLOW	5	10	15	20	25	30	35	40	45	50	PSI
	0.3	0.7	1	1.4	1.7	2.1	2.4	2.8	3.1	3.4	BAR
5	69	96	117	135	148	163	174	188	198	208	GPM
18.9	216	363	443	511	560	617	659	712	750	787	l/min

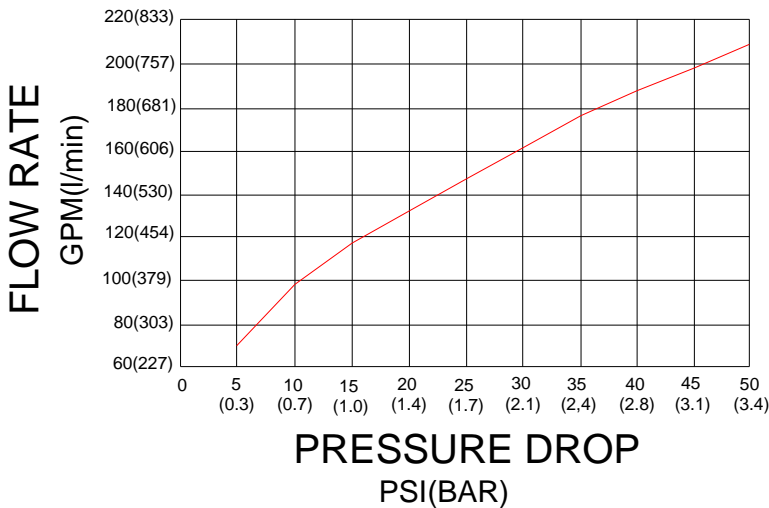

CAUTION! All thermostatic water mixing valves have limitations. They will NOT provide the desired accuracy outside of their flow capacity range. Consult the Flow Capacity Chart and DO NOT OVERSIZE. Minimum flow must be no less than as indicated.

LEONARD[®]
WATER TEMPERATURE CONTROLS

1360 Elmwood Avenue, Cranston, RI 02910 USA

Phone: 401.461.1200 Fax: 401.941.5310

Email: info@leonardvalve.com

Web Site: <http://www.leonardvalve.com>